



# DARCO

Industrial Cleaning Equipment - Sales & Service

2022 EDITION - V.1.1.5  
Darco NO-PRICE



# PRESSURE WASHERS

## PARTS - ACCESSORIES



DARCO  
Industrial Cleaning Equipment - Sales & Service

1-877-933-2726

[DarcoPressureWashers.com](http://DarcoPressureWashers.com)

# SALES, DISTRIBUTION & CORPORATE OFFICE

2380 Wycroft Road,  
Unit 16 Oakville, ON L6L 6W1  
CANADA

Toll free: 1-877-933-2726  
sales@darcopressurewashers.com

---

## SALES POLICY

No minimum order requirement.

## PAYMENT

**Open credit:** extended after submission and approval of the credit application.

**Credit card:** MasterCard & Visa + 2% fee

## OPEN CREDIT TERMS

After submitting Darco application for credit, and receiving approval from the credit department, open terms are established with our standard NET 30 days.

## PAST DUE INVOICES

Receiving open terms from Darco is a privilege reflecting your historical ability to meet your payment obligations in a timely manner. All our orders are invoiced the day of shipment. They are considered past due on the 31<sup>st</sup> day after shipment.

Credit manager will forward a friendly reminder when an invoice has become delinquent.

Please remember, it is your responsibility to honor your payment commitments to Darco. It is NOT our credit department's responsibility to inform a delinquent customer on a continuing basis as to invoices in arrears.

Frequent incidents of account delinquency will result in suspension of open term status and credit card payments only will be accepted for future orders.

Accounts with invoices 45 days are automatically placed on **CREDIT HOLD**. No shipments will be made until payment of past due invoice(s) is received by Darco.

## RETURNED CHECKS

A 35.00\$ fee will be charged on ALL checks returned to Darco, regardless of reason. This may cause your account to be placed on **PERMANENT** credit card status.

## SHIPPING STOCK ORDERS

Orders received by 2:00PM will ship the same day Monday through Friday. Darco customer service department will notify you as soon as possible in the case of unforeseen circumstances, such mechanical failure, power outages, weather related problems or other emergencies. Orders affected will be shipped within 24 hours except Fridays or before a holiday.

## ORDER PROCEDURES

In order to eliminate ordering error, we recommend e-mailing your orders. These orders are accepted 24 hours a day all year.

Our customer service department accepts telephone orders from 8:30 AM to 4:30 PM Monday through Friday except on holidays.

**Please provide the following information when ordering:**

1. Customer name
2. Company shipping address
3. Purchase order number or name
4. Special instructions, such a RUSH order
5. Customer phone number
6. Description of product
7. Quantity ordering

Your order will be repeated to you by our customer service representative line by line verifying quantity.

Please pay close attention as you will be responsible for any errors once order is entered.

## SHIPPING ERRORS AND DAMAGES

Shipping errors such as shortage or wrong items should be reported immediately to our customer service department.

Any packages received damaged or appear to have damage should be noted with your delivery company for inspection, then reported to Darco customer service.

## ADDRESS ERROR FEE

Dicom and Purolator charge a fee for incorrect addresses, which will be passed on to your account, unless it was an entry error by Darco customer service.

## BACKORDER / SPECIAL ORDERS

Customer will be notified when a back order or special order has been received to afford the opportunity to add to the order or hold for later shipment. Freight is charged on all back order shipments.

---

*All Darco prices, whether listed in this catalog or not, are subject to change with no prior notification. As well as product additions and deletions may occur without notice. Pictures shown in the catalog are representative of products available and may not be actual photos as manufacturers change items as does Darco.*

*We attempt to hold prices, and products for the duration of this catalog, but that is not always possible.*

*Darco is not responsible for typographical errors in this catalog.*

# TABLE OF CONTENTS

<b>PARTS</b>	<b>4</b>	<b>VACUUM / EXTRACTOR</b>	<b>51</b>
Hoses	5	Carpet extractor	52
Lances & Wands	7	Water heater/others	53
Miscellaneous	8	Mytee Replacement parts	54
Sewer/Drain Hose	9	Mobile Vacuum (made in Italy)	55
Rotating/Non-Rotating Sewel Nozzle	10	Vac Hoses & Cuffs	56
Hose reels	12	Vac Hose Reel	57
Spray Gun	14	Industrial Vacuum (Turbine)	57
Quick Coupler	16	Cyclonic Vacuum	58
Quick Plug	17	Tomador	59
Screw fitting & coupler	18	Sprayers	61
Swivel	20	Foamers	62
Swivel 90 Degree	21	<b>CARWASH / AUTOMOTIVE</b>	<b>63</b>
Oversize Swivel	22	Carwash Boom	64
Swivel/Miscellaneous	22	Curtain & Separation Walls	66
Bolt on Unloader	23	Flex Das Original	67
Trapped Unloader	24	<b>PUMPS</b>	<b>69</b>
Unloader	24	Mazzoni pumps	70
Pressure Trapped Unloader	25	GP / Interpump pumps	71
Regulator	26	AR pumps	75
Turbo Rotating Nozzle	30	UDOR pumps	77
Nozzle	32	Giant pumps	77
High Pressure fittings	34	Comet pumps	78
Electrical Component	35	<b>Miscellaneous</b>	<b>79</b>
Pressure Switch	37		
Flow Switch	38		
Brass fittings (Push-Lock)	39		
Brass fittings	40		
Filter and inlet fittings	42		
Steel fittings	43		
<b>MOTORS &amp; PULLEYS</b>	<b>46</b>		
Electric motor	47		
Belts & Pulleys	48		
Extension cord	49		

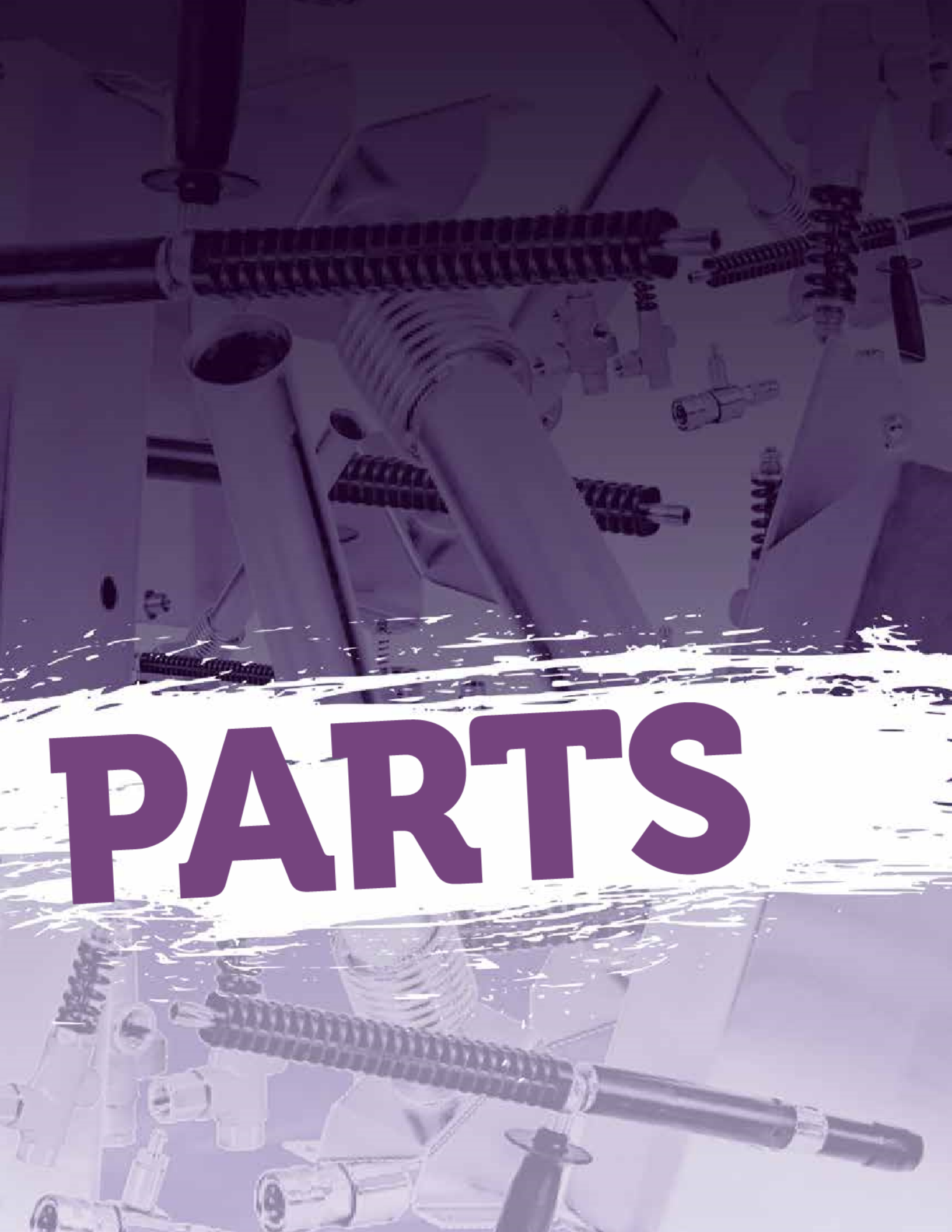

# PARTS

# Hoses



## PRESSURE WASHER HOSES

- High quality up to 4000 psi
- Single braid
- 140 to 250 F°
- Different standard length (custom length also available)
- 1/4 and 3/8 I.D.
- Blue color

Model	Description	ID	PSI	F° Maximum	Length	Price
PWH-4-25B	Pressure washer hose blue	1/4	4000	250 F°	25'	
PWH-4-50B	Pressure washer hose blue	1/4	4000	250 F°	50'	
PWH-4-100B	Pressure washer hose blue	1/4	4000	250 F°	100'	
PWH-6-30B	Pressure washer hose blue	3/8	4000	250 F°	30'	
PWH-6-50B	Pressure washer hose blue	3/8	4000	250 F°	50'	
PWH-6-75B	Pressure washer hose blue	3/8	4000	250 F°	75'	
PWH-6-100B	Pressure washer hose blue	3/8	4000	250 F°	100'	
PWH-6-150B	Pressure washer hose blue	3/8	4000	250 F°	150'	
PWH-6-300B	Pressure washer hose blue	3/8	4000	250 F°	300'	

\*Full hose reel available upon request

\*Crimp fitting NPT and JIC available upon request



## PRESSURE WASHER DOUBLE BRAID HOSES

- High quality up to 6000 psi
- Double braid last up to 2x than one-wire braid
- 140 to 250 F°
- Different standard length (custom length also available)
- 3/8 I.D.
- Gray color

Model	Description	ID	PSI	F° Maximum	Length	Price
PWH-6-30G	Pressure washer hose gray	3/8	6000	250 F°	30'	
PWH-6-50G	Pressure washer hose gray	3/8	6000	250 F°	50'	
PWH-6-75G	Pressure washer hose gray	3/8	6000	250 F°	75'	
PWH-6-100G	Pressure washer hose gray	3/8	6000	250 F°	100'	
PWH-6-150G	Pressure washer hose gray	3/8	6000	250 F°	150'	
PWH-6-200G	Pressure washer hose gray	3/8	6000	250 F°	200'	
PWH-6-300G	Pressure washer hose gray	3/8	6000	250 F°	300'	
SC-925-6C	Crimp 1 piece 3/8 x 3/8 NPT male					
SC-925SW-6C	Swivel Crimp 1 piece 3/8 x 3/8 NPT male					

\*Full hose reel available upon request

\*Crimp fitting NPT and JIC available upon request



## FAT-RESISTANT PRESSURE WASHER HOSES

- High quality up to 3000 psi
- Single braid
- 140 to 250 F°
- 3/8 I.D.
- Yellow color

Model	Description	ID	PSI	F° Maximum	Length	Price
PWH-6-50Y	Pressure washer hose yellow	3/8	3000	250 F°	50'	
PWH-6-75Y	Pressure washer hose yellow	3/8	3000	250 F°	75'	
PWH-6-100Y	Pressure washer hose yellow	3/8	3000	250 F°	100'	

# Hoses



## WATER PVC HELIX SUCTION HOSES

- Clear, flexible, supported by a rigid PVC helix
- -40 to 150 F°
- Smooth interior & exterior, abrasion and mild chemical resistant
- **PRICE PER FOOT**

Model	Description	ID	PSI @ 20°C	PSI @ 40°C	Bend Rad.	Price
G941BW-125	Vacuum PVC helix hose	1- <sup>1</sup> / <sub>4</sub>	90	65	4"	
G941BW-150	Vacuum PVC helix hose	1- <sup>1</sup> / <sub>2</sub>	90	65	5"	
G941BW-200	Vacuum PVC helix hose	2	90	65	7"	

\*Full hose reel (100ft.) available upon request



## PUSH-LOCK HOSE

- Due to its construction, no need for clamps when use with push-lock fittings (see page 35)
- -40 to 200 F°
- Smooth interior & exterior, light and flexible.
- **PRICE PER FOOT**

Model	Description	ID	OD	PSI @ 21°C	Price
G761-025	Push-lock hose	<sup>3</sup> / <sub>8</sub>	<sup>1</sup> / <sub>2</sub>	300	
G761-037	Push-lock hose	<sup>1</sup> / <sub>2</sub>	<sup>3</sup> / <sub>4</sub>	300	
G761-050	Push-lock hose	<sup>3</sup> / <sub>4</sub>	<sup>7</sup> / <sub>8</sub>	300	

\*Full hose reel (100ft.) available upon request



## WH8 + G311 INDUSTRIAL WATER HOSE

- Traditional PVC and true synthetic rubber hose used everywhere by contractors and homeowners.
- It is a rugged hose capable of handling most washdown and water conveying applications.
- Lightweight, two-spiral construction, this hose is the best choice for hot water applications and can also be used for low-pressure agricultural spray applications.

Model	Description	ID	LENGTH	MAX. PSI	Price
FF-WH8BLU-50H	<sup>1</sup> / <sub>2</sub> x 50' blue hose assembly	<sup>1</sup> / <sub>2</sub>	50	300	
FF-WH8BLU-75H	<sup>1</sup> / <sub>2</sub> x 75' blue hose assembly	<sup>1</sup> / <sub>2</sub>	75	300	
FF-WH10BLU-50H	<sup>5</sup> / <sub>8</sub> x 50' blue hose assembly	<sup>5</sup> / <sub>8</sub>	50	250	
FF-WH10BLU-75H	<sup>5</sup> / <sub>8</sub> x 75' blue hose assembly	<sup>5</sup> / <sub>8</sub>	75	250	
G311-075	<sup>3</sup> / <sub>4</sub> Industrial water hose (feet)	<sup>5</sup> / <sub>8</sub>	1	150	

\* Other sizes and full hose reel without assembly available upon request

# Lances & Wands

## Zinc Lances | Straight & Robust - 1/4 MNPT In/Out - Max. 220°F



Model	Length	Material	GPM	Max. PSI	Price
DL24ICS	24 inches	Zinc Plated	10	4000	
DL27ICS	27 inches	Zinc Plated	10	4000	
DL36ICS	36 inches	Zinc Plated	10	4000	
DL47ICS	47 inches	Zinc Plated	10	4000	
DL59ICS	59 inches	Zinc Plated	10	4000	
DL79ICS	79 inches	Zinc Plated	10	4000	

## Stainless Lances | Straight & Long Life - 1/4 MNPT In/Out - Max. 320°F



Model	Length	Material	GPM	Max. PSI	Price
4030300041	20 inches	Stainless Steel	10.5	5075	
4030300039	28 inches	Stainless Steel	10.5	5075	
4030300033	36 inches	Stainless Steel	10.5	5075	
4030300034	48 inches	Stainless Steel	10.5	5075	

## Double Lances | 1/4 MNPT In/Out - Max. 320°F (284°F for the 72 in. model)



Model	Length	Material	GPM	Max. PSI	Price
4030800007	42 inches	Stainless Steel	10.5	4050	
ZZDBL72	72 inches	Zinc Plated	10.5	4050	

## Blue Flexible Lance | 1/4 MNPT In/Out - Max. 200°F



Model	Length	Material	GPM	Max. PSI	Price
DL18FWBLMSS	18 inches	Stainless Steel	10	2500	

## Telescopic Lances | 1/4 MNPT In/Out - Max. 195°F



Model	Length	Material	GPM	Max. PSI	Price
DCLTG18	18 feet	Fiberglass	10.5	4000	
DCLTG24	24 feet	Fiberglass	10.5	4000	

## Wand Belt | For telescopic Lance

Model	Length	Material	GPM	Max. PSI	Price
D20015	N/A	Nylon	N/A	N/A	

# Miscellaneous



## Industrial Underbody Wash | On Caster Wheels

### Features:

- Included 2 Nozzles
- Rust proof component made with Stainless Steel & Brass
- Come with 2 Quick-Connect 1/4" for hose
- Made in Canada

Model	Length	Material	GPM	Max. PSI	Price
UNDER	4 feet	Stainless Steel	10.5	4000	



## Inlet King Nipple | For Gravity Feed Systems

Model	Size	Material	Price
FT783114	1-1/4" Hose barb x 1/2 MNPT	Zinc-Plated Steel	
FT783112	1-1/2" Hose barb x 3/4 MNPT	Brass	
FT783113	2" Hose barb x 1" MNPT	Brass	



## Pulsation Dampener

Model	Size	GPM	PSI	Price
4139500025	3/8 FNPT Nitrogen Filled	8	3650	
4139500026	1/2 FNPT Nitrogen Filled	10	3650	
686010	1/2 FNPT Nitrogen Filled	10	3000	
686011	3/4 FNPT Nitrogen Filled	40	3000	
A15	3/4 FNPT Nitrogen Filled	105	4780	



## Bottom Mount Gauge

Model	Size	PSI	Price
320002	1/4 NPT Glycerin Filled	3000	
320003	1/4 NPT Glycerin Filled	5000	



## Back Mount Gauge

Model	Size	PSI	Price
320000	1/4 NPT Glycerin Filled	3000	



# Sewer / Foot Valve



## Foot Valve 3000 PSI | SUTTNER

### Features:

- Pedal and valve are in protective housing
- Inlet and outlet are positioned to help keep hose out of the way
- Heavy gauge steel construction for durability and stability
- Can be used in other applications
- Inlet: 3/8" FPT
- Outlet: 1/4" FPT
- Maximum Pressure: 3,000 PSI
- Max. Flow Rate: 8.0 GPM
- Max. Temp.: 320° F.

Model	Description	Size	Price
999000012	Valve foot-operated 3000 PSI	inlet 3/8 x outlet 1/4	



## Industrial foot valve 5000 PSI | GENERAL PUMP

### Features:

- Offers hands-free operation!
- Sturdy, heavy-gauge steel construction
- Powder coated for durability
- Reliable design
- Protected pedal guards against accidental activation
- Inlet: 3/8" FPT
- Outlet: 1/4" FPT
- Maximum Pressure: 5,000 PSI
- Max. Flow Rate: 10.0 GPM
- Max. Temp.: 320° F.

Model	Size	GPM	PSI	Price
DFV5010	3/8 FNPT IN - 1/4 FNPT OUT	10	5000	

# Sewer / Drain Hose



## SEWER CLEANER HOSE

- Smooth polyolefin designed for maximum resistance to hydrolysis.
- High tensile polyester textile yarn.
- -40°C (-40°F) to 87°C (190°F).
- Abrasion, cut, and fungus resistant polyurethane.
- Factory installed male NPT fittings.
- Fungus resistance.

Model	Description	ID	LENGTH	MAX. PSI	Price
186SC-02-50	1/8 x 50' assembly	1/8	50	4000	
186SC-02-75	1/8 x 75' assembly	1/8	75	4000	
186SC-02-100	1/8 x 100' assembly	1/8	100	4000	
186SC-04-50	1/4 x 50' assembly	1/4	50	4000	
186SC-04-75	1/4 x 75' assembly	1/4	75	4000	
186SC-04-100	1/4 x 100' assembly	1/4	100	4000	
186SC-04-150	1/4 x 150' assembly	1/4	150	4000	
186SC-04-200	1/4 x 200' assembly	1/4	200	4000	
186SC-06-50	3/8 x 50' assembly	3/8	50	4000	
186SC-06-75	3/8 x 75' assembly	3/8	75	4000	
186SC-06-100	3/8 x 100' assembly	3/8	100	4000	
186SC-06-150	3/8 x 150' assembly	3/8	150	4000	
186SC-06-200	3/8 x 200' assembly	3/8	200	4000	

\* Other sizes and length available upon request

# Rotating/Non-Rotating Sewer Nozzle



## Non-Rotating mini Sewer nozzle | 1/8, 1/4 & 3/8 Inlet - 4200PSI

- Nozzles with forward ports blast through and break up clogs
- Rear ports thrust nozzle forward and flush debris
- 1/8 ideal for 1" - 3" lines
- 1/4 ideal for 2" - 4" lines
- Stainless steel
- Great cornering ability
- 3/8 ideal for 4" - 8" lines

To  
UNCLOG

Size	Nozzle	O.D.
1/8" FNPT	035 to 100	.59"
1/4" FNPT	040 to 120	.75"
3/8" FNPT	070 to 200	.920"



## ST-49 Rotating Sewer nozzle | 1/8, 1/4 & 3/8 Inlet - 4000PSI

- Brass and Stainless Construction
- Ideal for cleaning or flushing pipes
- 1/8 ideal for 1" - 3" lines
- 1/4 ideal for 2" - 4" lines
- 3/8 ideal for 4" - 8" lines

To  
CLEAN PIPE

Size	Nozzle	O.D.
1/8" FNPT	045 to 80	.74"
1/4" FNPT	040 to 120	.74"
3/8" FNPT	040 to 180	.94"

INLET	NOZZLE SIZE	NON-ROTATING			ROTATING		
		MECLINE	SUTTNER	PRICE	MECLINE	SUTTNER	PRICE
1/8 F	035		120155375				
1/8 F	040	0124722200			0124722510		
1/8 F	045	0124722210			0124722520	200049825	
1/8 F	050		122375175		0124722530	200049830	
1/8 F	055	0124722220	122370170			200049650	
1/8 F	060		122385185		0124722540	200049840	
1/8 F	065	0124722230	122390190				
1/8 F	070					200049845	
1/8 F	075		122300100				
1/8 F	080					200049850	
1/8 F	100		122320120				

# Rotating/Non-Rotating Sewer Nozzle

		NON-ROTATING			ROTATING		
INLET	NOZZLE SIZE	MECLINE	SUTTNER	PRICE	MECLINE	SUTTNER	PRICE
1/4 F	035		121360170				
1/4 F	040	0124722240			0124722560	200049794	
1/4 F	045	0124722250	121370170		0124722570	200049795	
1/4 F	050				0124722580	200049800	
1/4 F	055	0124722260	121375175			200049600	
1/4 F	060		121470170		0124722590	200049810	
1/4 F	065	0124722270					
1/4 F	070					200049815	
1/4 F	075		121480180				
1/4 F	080		121395195		0124722595	200049610	
1/4 F	090		121310000			200065161	
1/4 F	100		121320010				
1/4 F	120		121320000			200065162	

		NON-ROTATING			ROTATING		
INLET	NOZZLE SIZE	MECLINE	SUTTNER	PRICE	MECLINE	SUTTNER	PRICE
3/8 F	035						
3/8 F	040	124722080	123065188			200049860	
3/8 F	045	0124722090			0124722610	200049870	
3/8 F	050				0124722620	200049880	
3/8 F	055	0124722100	123065187		0124722630		
3/8 F	060				0124722640	200049890	
3/8 F	065	0124722110					
3/8 F	070	0124722510	123065184				
3/8 F	075						
3/8 F	080				0124722660	200049891	
3/8 F	085		123065189				
3/8 F	090						
3/8 F	100					200049892	
3/8 F	120		123065186			200049893	
3/8 F	140		123065185				
3/8 F	150		123065182			200049894	
3/8 F	200		123065181			200049895	

# Hose reels



## MANUAL REWIND WATER OR AIR

- MFG by **General Pump**
- All steel made
- A-type frame for maximum strength
- High quality Suttner swivel ST-321 up to 4000 psi

Model	Description	Hose	Price
DHRA50150	Manual rewind	150' of 3/8	
DHRA50300	Manuel rewind	300' of 3/8	
DHRA50450	Manual rewind	450' of 3/8	
2103410	Kit electric rewind 12 volt (assembly required)		
2100437	Stackable hose reel		



## CoxReel *(Hose not included)*

Model	Description
112-3-100	Hand crank Hose reel. Working pressures up to 4,000 PSI - 100'
112-3-150	Hand crank Hose reel. Working pressures up to 4,000 PSI - 150'



## RAMEX | Manual hose reel

Model	Description	PSI	Hose	Price
AVM9811-400	Hose reel Stainless steel	5800	100' of 1/2	
AVM9920FE-200	Hose reel Powder coating steel	2900	200' of 1/2	
AVM9920-400	Hose reel Stainless steel	5800	200' of 1/2	
AVM9850-400	Hose reel Stainless steel	5800	250' of 1/2	
AVM9851	Hose reel Stainless steel	1100	100' of 1"	



## Carry on Hose reel GP

Model	Description	Price
2100357	Hose reel on base hand carry	
2100278	Repair Kit	



## Trailer mounted Hose Reel GP

Model	Description	Price
DHRTM50200	Trailer mounted hose reel. Up to 5000 PSI. Can hold 200' of 3/8" Hose	



## Hose reel cart *(Hose reel and hose not included. Photo show reel and cart assembly)*

Model	Description	Price
2100465	Hose reel cart GP reel (serie DHRA)	

\* We carry a large inventory of hose reel parts and high pressure swivel in stock. Hose sold separately.

# Hose reels



## SPRING REWIND WATER OR AIR

- MFG By **Ramex** (made in Italy)
- Steel or stainless steel available (WHITE OR GRAY COLOR IS STANDARD)
- Outlast any other swivel on the market (**5800 PSI**)
- Slow retraction device available
- Option stainless 316 available
- Option for fluid OIL, DEF, FUEL
- Hose stop included
- **Hose sold separately**
- **Ship by truck only.**



## 3000 PSI SERIES (SWIVEL MADE WITH CARBON STEEL)

Model	Description	Hose	Price
HR1100 FE200	Hose reel auto rewind ( <i>powder coated</i> )	50' of ½	
HR3500 FE200	Hose reel auto rewind ( <i>powder coated</i> )	100' of ½	
KITBK	Safety slow retraction device (assembly required)		
2.0.02.0002	Repair Kit Ratchet		
KIT11	Swivel repair kit 3000 PSI		
4963	Swivel Stainless 3000 PSI		

\*We carry a large inventory of hose reel parts and high pressure swivel in stock. Hose sold separately.

## 5800 PSI SERIES (BEST SWIVEL ON THE MARKET MADE WITH STAINLESS STEEL, HIGH PRESSURE SEAL PACKING)

Model	Description	Hose	Price
<b>POWDER COATED PAINT MODELS</b>			
HR1000 FE400	Hose reel auto rewind ( <i>powder coated</i> )	40' of ½	
HR1100 FE400	Hose reel auto rewind ( <i>powder coated</i> )	50' of ½	
HR3500 FE400	Hose reel auto rewind ( <i>powder coated</i> )	100' of ½	
HR6000 FE400	Hose reel auto rewind ( <i>powder coated</i> )	200' of ½	
<b>STAINLESS STEEL MODELS</b>			
HR1100400	Hose reel auto rewind ( <i>stainless steel</i> )	50' of ½	
HR3500400	Hose reel auto rewind ( <i>stainless steel</i> )	100' of ½	
HR6000400	Hose reel auto rewind ( <i>stainless steel</i> )	200' of ½	
KITBK	Safety slow retraction device (assembly required)		
2.0.02.0002	Repair Kit Ratchet		
RXKit 400	Swivel repair kit 5800 PSI		
4962 400	Swivel Stainless 5800 PSI		

\*We carry a large inventory of hose reel parts and high pressure swivel in stock. Hose sold separately.

## PIVOTING BASE FOR HOSE REEL (FOR HR1000-HR1100-HR3500)

Model	Description	Price
ST15 FE	Hose reel pivoting plate Ramex HR1000/HR1100 ( <i>powder coated</i> )	
ST30 FE	Hose reel pivoting plate Ramex HR3500 ( <i>powder coated</i> )	

\*We carry a large inventory of hose reel parts and high pressure swivel in stock. Hose sold separately.

# Spray Gun



## MV925 | Pressure washer gun | Mecline relax handle

Model	Description	PSI	GPM	Price
4012205005	Pressure washer gun	4500	8	
4019900025	Repair kit			



## MV925SW | Pressure washer gun built-in swivel

Model	Description	PSI	GPM	Price
4012305005	Pressure washer gun MV925 with integrated swivel	4500	8	
4019900025	Repair kit			



## ST-1500 | Pressure washer gun | Suttner

Model	Description	PSI	GPM	Price
ST-1500	Pressure washer gun	5000	12	
201500496	Repair kit			



## ST-2305 | Pressure washer gun | Suttner Relax handle

Model	Description	PSI	GPM	Price
ST-2305	Pressure washer gun	5000	12	
202300490	Repair kit			



## ST-2605 | Pressure washer gun | Suttner cam action

Model	Description	PSI	GPM	Price
ST-2605	Pressure washer gun	5000	12	
202300490	Repair kit			

# Spray Gun



## ML510 | Pressure washer gun | Mecline

Model	Description	PSI	GPM	Price
ML510	Pressure washer gun, in/out ½	8700	16	
4019900049	Repair kit			



## YG4500S | Linear pressure washer gun

Model	Description	PSI	GPM	Price
YG4500S	Linear pressure washer gun	5000	10.5	



## YG1317S | Water low pressure gun

Model	Description	PSI	GPM	Price
YG1317S	Water low pressure gun with integrated swivel	350	13.2	



## YG1635S | Water low pressure gun

Model	Description	PSI	GPM	Price
YG1635S	Water low pressure gun with integrated swivel	350	16	

# Quick Coupler

## Quick coupler | Female



Model	Description		Size	Type	Price
D10001	Quick coupler	Brass	1/4	Female	
D10003	Quick coupler	Brass	3/8	Female	
D10072	Quick coupler	Stainless	1/4	Female	
D10074	Quick coupler	Stainless	3/8	Female	
D10090	Quick coupler	Stainless	1/2	Female	



## Quick coupler | Male



Model	Description		Size	Type	Price
D10002	Quick coupler	Brass	1/4	Male	
D10004	Quick coupler	Brass	3/8	Male	
D10073	Quick coupler	Stainless	1/4	Male	
D10075	Quick coupler	Stainless	3/8	Male	
D10091	Quick coupler	Stainless	1/2	Male	



QC-1/4  
1/4F



QC-1/4  
1/4M



QC-3/8  
3/8F



QC-3/8  
3/8M



QC-3/8  
1/2M



QC-1/2  
1/2F



QC-1/2  
1/2M

Real size  
measurements



# Quick Plug



## Quick plug | Female

Model	Description		Size	Type	Price
D10076	Quick connect plug	Stainless	¼	Female	
D10078	Quick connect plug	Stainless	¾	Female	
D10092	Quick connect plug	Stainless	½	Female	



## Quick plug | Male

Model	Description		Size	Type	Price
D10077	Quick connect plug	Stainless	¼	Male	
D10079	Quick connect plug	Stainless	¾	Male	
D10093	Quick connect plug	Stainless	½	Male	



**QP-1/4**  
1/4F



**QP-1/4**  
1/4M



**QP-3/8**  
3/8F



**QP-3/8**  
3/8M



**QP-1/2**  
1/2F



**QP-1/2**  
1/2M

## O-ring



Model	Description		Size	Type	Price
100703	O-ring (package)	¼ x 25	¼	Viton	
100702	O-ring (package)	¾ x 25	¾	Viton	
100702-1	O-ring	¾	¾	Viton	
100703-1	O-ring	¼	¼	Viton	

# Screw fitting & coupler

## Screw fitting

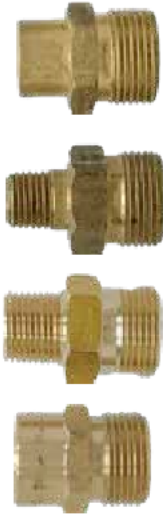

Model	Description	Size	Price
2510103	Screw fitting	¼ F plug x M22	
D10021	Screw fitting	¼ M plug x M22	
D10023	Screw fitting	¾ M plug x M22	
D10024	Screw fitting	¾ F plug x M22	

## Screw coupler



Model	Description	Size	Price
D10027	Screw coupler	¼ F x M22 o-ring	
D10028	Screw coupler	¼ M x M22 o-ring	
D10029	Screw coupler	¾ F x M22 o-ring	
D10030	Screw coupler	¾ M x M22 o-ring	

## Metric O-ring



Model	Description	Size	Type	Price
100150	Metric O-ring	15 mm	Viton	

# Screw fitting & coupler

## Real size measurements

Just put your coupler or fitting over the image to determine your needed size



Screw fitting  
1/4M x M22



Screw fitting  
3/8M x M22



Screw fitting  
1/8F x M22



Screw fitting  
1/4F x M22



Screw coupler  
1/4M x M22



Screw coupler  
3/8M x M22



Screw coupler  
3/8F x M22



Screw coupler  
1/4F x M22

Kothar is a Netherlands manufacturer of high quality components at unbeatable prices



### Inline Live Swivel | Kothar

Model	Description	PSI	Size	Pack	Price
300180137	Inline Brass Swivel	3000	1/4 F BSP x 3/8 F NPT	1	
302180132	Inline live Swivel Brass / Nickel / Stainless	4300	3/8 M x F	1	



### Inline Live Swivel | Kothar

Model	Description	PSI	Size	Pack	Price
302180672SS	Inline live Swivel Stainless	4300	3/8 M x F	1	



### Inline Live Swivel | Kothar

Model	Description	PSI	Size	Pack	Price
302180136	Inline live Swivel	4300	3/8 F x F	1	



### Economic Inline Swivel | Kothar

Model	Description	PSI	Size	Pack	Price
302180 501	Inline Swivel Stainless	3625	3/8 M x F	1	



### Economic Inline Swivel | Kothar | 1/2 NPT

Model	Description	PSI	Size	Pack	Price
302180 010	Inline Swivel Stainless	2900	1/2 M x F	1	

# Swivel 90°



## Swivel 90° | 4 bearing | Kothar | 1/2 NPT

Model	Description	PSI	Size	Price
<b>Stainless steel</b>				
302090190	Swivel 90°, 4 bearing	7300	½ M x F	
302090191	Swivel 90°, 4 bearing	7300	½ F x F	
302090192	Swivel 90°, 4 bearing	7300	¾ F x ½ F	



## Swivel 90° | 2 bearing | Kothar | 1/2 NPT

Model	Description	PSI	Size	Price
<b>Stainless steel</b>				
302090692	Swivel 90°, 2 bearing	5000	¾ M x ¾ F	

## Swivel 90° | Kothar



Model	Description	PSI	Size	Price
<b>Brass / Stainless steel</b>				
302090132	Swivel 90°	2200	¼ M x F	
302090133	Swivel 90°	2200	¾ M x F	
302090134	Swivel 90°	2200	¾ M x ¼ F	
302090135	Swivel 90°	2200	¼ M x ¾ F	
302090330	Stainless Swivel 90°	3000	¼ M x F	
302090331	Swivel 90°	3000	¾ M x ¾ F	
302090332	Swivel 90°	3000	¼ M x ¾ F	



## Swivel 90° | Kothar | 3/8 NPT

Model	Description	PSI	Size	Price
<b>Stainless steel</b>				
302090690	Swivel 90°	5000	¾ M x ¾ F	

# Oversize Swivel



## Inline Live Swivel | Kothar | 3/4 NPT - 1" NPT

Model	Description	PSI	Size	Price
302180683	Stainless <i>Full Flow</i>	3625	1/2 M x F	
302180684	Stainless <i>Full Flow</i>	3625	3/4 M x F	



## Swivel 90° | 4 bearing | Kothar | 3/4 NPT - 1" NPT

Model	Description	PSI	Size	Price
<b>Stainless steel</b>				
302090195	Swivel 90°, 4 bearing	7300	3/4 M x F	
302090199	Swivel 90°, 4 bearing	7300	1" M x F	

# Swivel/Miscellaneous



## Swivel 90° | Suttner

Model	Description	PSI	Size	Price
200321510	Swivel 90°, ST-321 FNPT	5000	1/2 F x 3/8 F	



## Swivel | 90° J.E. Adams

Model	Description	PSI	Size	Price
<b>Brass</b>				
7030-2608	Brass Swivel	4000	3/8 M x F	
<b>Stainless Steel</b>				
7035-2295	Stainless Steel Swivel	4000	3/8 M x F	



## Swivel | Floor cleaner spinner | Kothar

Model	Description	PSI	Size	RPM	Price
<b>Brass / Stainless steel</b>					
302180341	Swivel for floor cleaner	4000	3/8 M x F	2700	

# Bolt on Unloader



## Bolt-on Unloader | Mecline

Model	Description	PSI	GPM	Max temp	Price
4072401013	Bolt on Unloader VRF2 (Banjo kit sold separately)	4500	8	194°F	



## Pressure Trapped Unloader with integrated Pressure Switch

4072000029	Bolt on Unloader VRF2-P (Banjo bolt sold separately)	3625	8	194°F	
------------	---	------	---	-------	--



## Banjo kit for VFR2 and VFR2-P

	Bolt A	Bolt B	
4073900003	G3/8	G1/2	Interpump E1-E2-E3 / General pump EP
4073900000	G3/8	G1/2	Interpump / General pump Series 44-47-50-60-63-91-99-151-154 SPECK NP16 - LEUCO NHD UDOR - COMET RW
0215200502	G3/8	G1/2	COMET LW-ZW / Interpump 94
4073900002	G3/8	G1/2	A&R XM-XT-XR-HPE-RK-RR COMET FW BERTOLINI TW-TML-TWE-VML-KWE

# Check Valve



## Check Valve | Mecline | 90°C/194°F | CV3 - CV5

Model	Name	Rate Flow	PSI	Size	Price
40740000001	CV3	10.5 GPM	5200	3/8 F x F	
40740000002	CV3	21 GPM	5200	1/2 F x F	
40740000005	CV5	10.5 GPM	7250	3/8 F x F	
40740000006	CV5	21 GPM	9280	1/2 F x F	

# Unloader



## Unloader (PA)

Model	Description	PSI	GPM	Max temp	Price
YVB135KDM	Unloader in 1/4 MNPT / out 3/8 MNPT Fit GP series 51	2600	6.5	194°F	
YVB351KDM	Unloader in 3/8 MNPT / out 1/2 MNPT Fit GP series 51	3650	6.5	194°F	
YVB75KDMN	Unloader in 3/8 MNPT / out 1/2 MNPT Fit GP series 47, 60, 63	3650	7.8	194°F	



# Trapped Unloader



## Pressure Trapped Unloader with integrated Pressure Switch

Model	Description	PSI	GPM	Max temp	Price
4072000009	Unloader VRT3-310 (Mecline) In 3/8 FNPT / out 3/8 FNPT (2) by-pass 3/8 female npt /	3200	10.5	194°F	
YVB8KMS	Unloader (PA) In 3/8 male BSP Out 3/8 female BSP / by-pass 3/8 female BSP	3200	8	195°F	





# Pressure Trapped Unloader



## VR54-200 | Unloader | Mecline

Model	Description	PSI	GPM	Max temp	Price
4072000041	Unloader VR54-200 In 3/8 MNPT, out 3/8 FNPT By-pass 3/8 female	2600	8	194°F	



## VR56-250 | Unloader | Mecline

Model	Description	PSI	GPM	Max temp	Price
4072000029	Unloader VR56-250 In 3/8 MNPT, out 3/8 FNPT By-pass 3/8 female	3650	8	194°F	



## VRT3 | Mecline

Model	Description	PSI	GPM	Max temp	Price
0215010310	Unloader <b>VRT3-310</b> (2) in 3/8 FNPT / out 3/8 FNPT (2) by-pass 3/8 female NPT	3600	10.5	194°F	
0215010320	Unloader <b>VRT3-310EZ</b> (2) in 3/8 FNPT / out 3/8 FNPT (2) by-pass 3/8 female NPT	4500	10.5	194°F	
4072000002	unloader <b>VRT3-310EZ</b> (2) in 3/8 FNPT / out 3/8 FNPT (2) by-pass 3/8 female NPT	4500	10.5	194°F	



## Unloader | PA

Model	Description	PSI	GPM	Max temp	Price
YVB8K	Unloader In 3/8 male BSP / out 3/8 female BSP By-pass 3/8 female BSP	3200	8	195°F	



## Unloader | PA

Model	Description	PSI	GPM	Max temp	Price
YVB4021HT	Unloader In 1/2 FNPT / out 1/2 FNPT By-pass 1/2 female NPT	4050	21	195°F	

# Pressure Trapped Unloader



## Unloader VB-350 | PA

Model	Description	PSI	GPM	Max temp	Price
YU5075K	Unloader In 3/8 MNPT / out 3/8 FNPT By-pass 1/2 female NPT	5075	10	195°F	



## VHP39 | Unloader | Mecline

Model	Description	PSI	GPM	Max temp	Price
4072000013	Unloader In 3/8 MNPT / out 3/8 FNPT (2) By-pass 1/2 female NPT	5650	10.5	194°F	



## Unloader | Giant

Model	Description	PSI	GPM	Max temp	Price
22913A	Unloader In 1/2 FNPT / out 1/2 FNPT By-pass 1/2 female NPT	3500	13	165°F	



## VRT100 | Unloader | Mecline

Model	Description	PSI	GPM	Max temp	Price
4072000077	Unloader (2) In 1/2 FNPT / out 1/2 FNPT (2) By-pass 1/2 female NPT	2760	26.4	194°F	



## Unloader | Stainless steel | Kothar

Model	Description	PSI	GPM	Max temp	Price
102050112	Stainless steel unloader (3/8) (2) in 3/8 FNPT / out 3/8 FNPT (2) by-pass 3/8 female NPT	3625	8	195°F	
102050210	Stainless steel unloader (1/2) (2) in 1/2 FNPT / out 1/2 FNPT (2) by-pass 3/8 female NPT	2100	15	195°F	
102050212	Stainless steel unloader (1/2) (2) in 1/2 FNPT / out 1/2 FNPT (2) by-pass 3/8 female NPT	3625	15	195°F	
102050710	Stainless steel unloader (3/4) (2) in 3/4 FNPT / out 3/4 FNPT (2) by-pass 3/8 female NPT	2175	35	195°F	

\* Last up to 2 years on multiple gun

# Pressure Trapped Unloader



## Regulator / Safety Relief Valve | Mecline

Model	Description	PSI	GPM	Max temp	Price
4073500003	SVL50 Valve In 1/2 FNPT / Out 1/2 FNPT	8100	26.4	194°F	



## VHP51 | Unloader | Mecline

Model	Description	PSI	GPM	Max temp	Price
4072000122	VHP51 Unloader Nickel Plated / Stainless Steel In 1/2 FNPT / Out 1/2 FNPT By-pass 1/2 FNPT	7250	26.4	194°F	



## VHP18 | Unloader | Mecline

Model	Description	PSI	GPM	Max temp	Price
4072000114	VHP18/160 Unloader In 3/4 FNPT / Out 3/4 FNPT By-pass 3/4 FNPT	2320	42.3	194°F	



## VHP31 | Unloader | Mecline

Model	Description	PSI	GPM	Max temp	Price
407200094	VHP31/150 Unloader (Grey Spring) In 1 FNPT / Out 1 FNPT By-pass 1 FNPT	2175	66	194°F	
407200095	VHP31/280 Unloader (Black Spring) In 1 FNPT / Out 1 FNPT By-pass 1 FNPT	4060	66	194°F	



## VHP70 | Unloader | Mecline

Model	Description	PSI	GPM	Max temp	Price
4072201003	VHP70 Stainless Steel Unloader In 1/2 FNPT / Out 1/2 FNPT By-pass 1/2 FNPT	9280	21	194°F	

# Regulator



## SVT28 | Pressure Regulator | Mecline

Model	Description	PSI	GPM	Max temp	Price
0215010190	SVT28 Regulator Brass body / Stainless Steel In 3/8 FNPT / Out 3/8 FNPT By-pass 3/8 FNPT	3625	66	194°F	



## SVL28 | Pressure Regulator | Mecline

Model	Description	PSI	GPM	Max temp	Price
0215010220	SVL28 Regulator Brass body / Stainless Steel In 3/8 FNPT / By-pass 3/8 FNPT	3625	6.6	194°F	



## YBRV5325 | Pressure Regulator | GP

Model	Description	PSI	GPM	Max temp	Price
YBRV5325	Brass body / Stainless Steel In 3/4 FNPT / Out 1/2 FNPT	2600	53	195°F	



## YBRV5325 | Bypass Valve | Kothar

Model	Description	PSI	GPM	Max temp	Price
102070055	In 3/8 FNPT / Out 3/8 FNPT By-pass 3/8 FNPT	2300	9.3	175°F	



## Pressure Regulator SS | Kothar

Model	Description	PSI	GPM	Max temp	Price
102070240	In 3/4 FNPT / Out 3/4 FNPT By-pass 1" FNPT	2200	18.6	175°F	